

View Caching

View caching allows you to store the data a view returns into a nominated writable database (including the in-memory database). To do this you must already have a writable source connection established.

1. Navigate to the Browse page and search for the view.
2. Access the View Summary option from the view's menu.

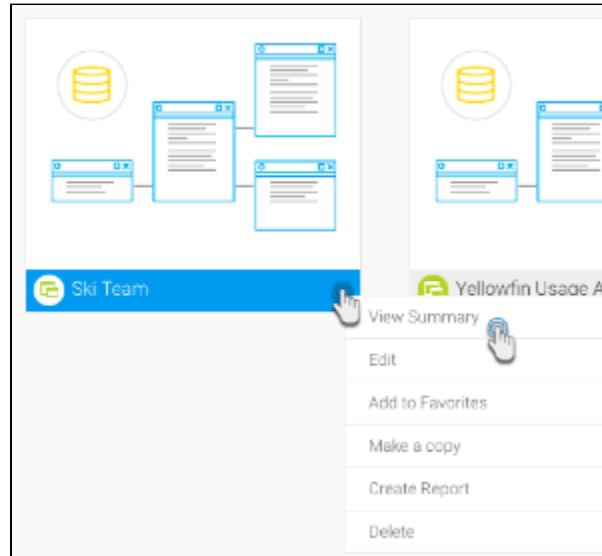

3. Click on the Cache tab. (Note: If you do not see this tab, ensure that you have a writable data source.)
4. You will now have a series of options to configure.

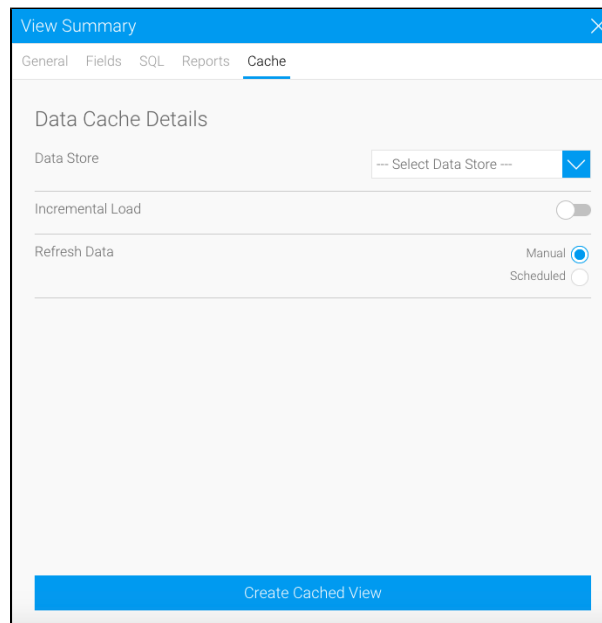

5. Select the name of the writable data store you have setup.
6. Decide if you wish the caching to be incrementally loaded. This is done by enabling the Incremental Load toggle. On doing so, you will be prompted to select an incremental load key from the view.

Incremental Load

☒

Incremental Load Key

--- Select an Incremental Loa...

This field must be an incrementing column. It will be used to determine which records are new since the previous refresh.

7. Select the incremental load key. This field must be an incrementing column as it will be used to determine which records are new since the previous refresh.
8. Choose whether to refresh your view cache manually, or set up a schedule to regularly cache its data.
 - a. On choosing the schedule option, additional fields will appear.

Refresh Data

Manual ☐
Scheduled ☒

Refresh Schedule

Weekly

▼

Saturday

▼

Advanced settings ↓

- b. Use these fields to set the refresh schedule. For example, you can set the view data to be cached on a monthly basis.

Refresh Schedule

Monthly

▼

Day: 3

Australia

▼

Sydney (+11:0...

▼

9 am

▼

:00

▼

Less ↑

This will run every month, on the 3rd day of the month .

- c. Note: The view will wait for the scheduled date to populate the first set of data to cache it.

9. Click Create Cached View. Depending on the number of records and the complexity of the view logic, this task may take several minutes. The following screen will then appear.

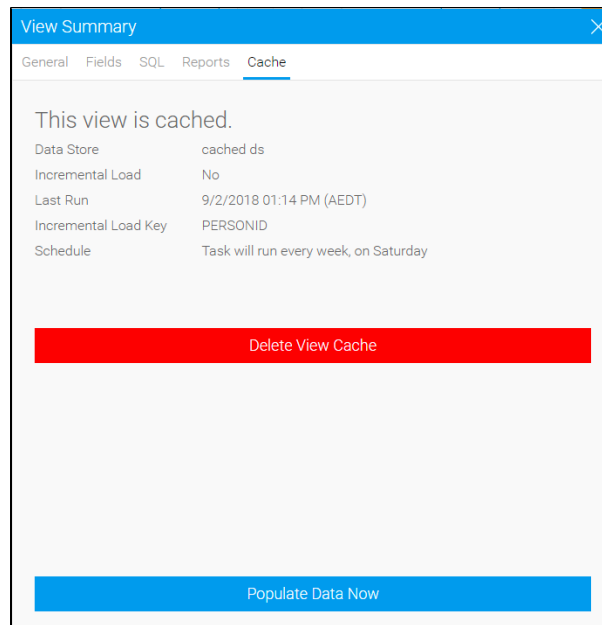

10. If you had created a schedule, the view is will be set to regularly cache its data, but will wait for the scheduled date to populate the first set of data.
11. However, if you wish to populate the data manually, click the Populate Data Now button. Yellowfin will now populate the data.

