

Yellowfin for AWS

- [Overview](#)
- [Setup](#)
 - [Amazon Elastic Compute Cloud \(EC2\) Settings](#)
 - [Location](#)
 - [Create Instance](#)
 - [Choose an Amazon Machine Image \(AMI\)](#)
 - [Choose Instance Type](#)
 - [Review & Launch](#)
 - [View Instances](#)
 - [Instance Name](#)
 - [Public IP](#)
- [Yellowfin](#)
 - [Open Yellowfin](#)
 - [Register Yellowfin](#)

Overview

[top](#)

You are now able to set up an instance of Yellowfin for AWS quickly and easily, aiding in evaluation setup. This offer includes:

- **Ready to go AWS deployment:** Yellowfin with all of its tutorial content to demonstrate reports, dashboards, and storyboards.
- **Free 1 Year licence for 3 users:** the licence is designed to allow you to full evaluate the system, allowing you to buy once you've ticked all the boxes.
- **Connection to Redshift:** Yellowfin can connect to Redshift in order to store your data and generate reports without setting up an external database.

Setup

[top](#)

Amazon Elastic Compute Cloud (EC2) Settings

1. Log in to Amazon Web Services (AWS)

2. Open the **Services** menu at the top of the page, click on **E C2** within the **Compute & Networking** category.



Location

While in the EC2 Dashboard it's important to select the closest location to your users. This will generally result in the fastest response times.

3. Click on the **Location** currently in use next to your name at the top right of the page.

4. Select the location closest to you.

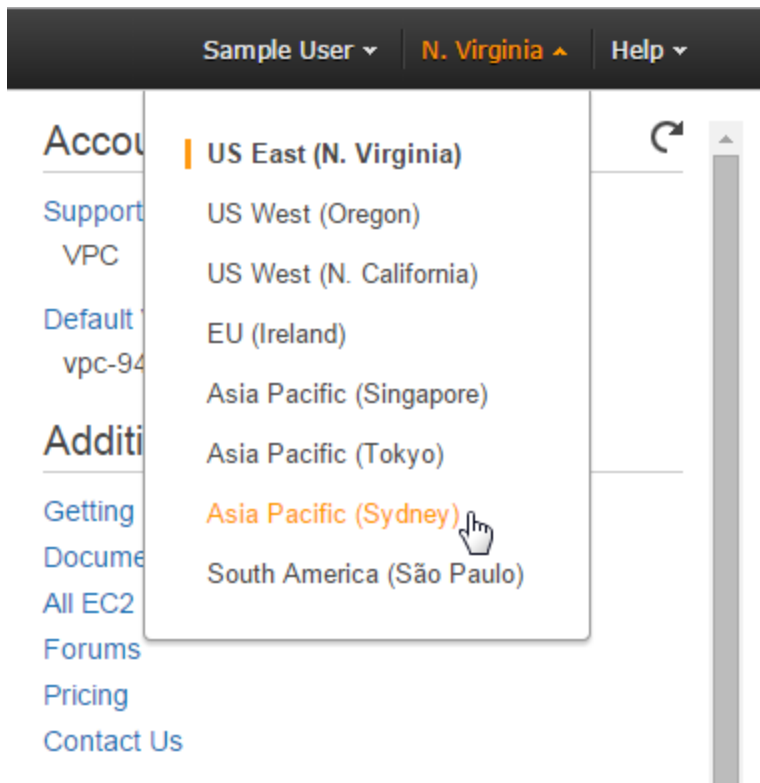

Create Instance

5. While still on the EC2 Dashboard, click on the **Launch Instance** button under the **Create Instance** heading.

From here you will be walked through a setup process where you define and configure the instance.



Choose an Amazon Machine Image (AMI)

6. The first step in the process is to select the image you wish to use. Under the **Community AMIs** section, search for the **Yellowfin** AMI.

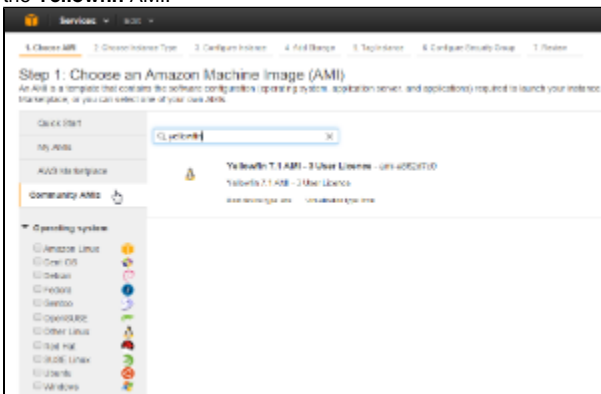

7. Once you've located the Yellowfin AMI, click on it and press the **Select** button.



Yellowfin 7.1 AMI - 3 User Licence - ami-a862d7c0

Yellowfin 7.1 AMI - 3 User Licence

Root device type: ebs Virtualization type: hvm

Select

64-bit

Choose Instance Type

From here, you will need to define the type of instance you wish to use. This will define the CPU, memory, storage, and networking capacity allocated to the instance.

For evaluation purposes, the t2.micro type is fine, and is free to use. For production purposes the t2.medium or higher options are recommended.

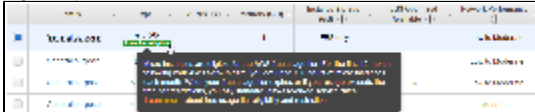

8. Select the type you wish to use (t2.micro for free use).

9. Click the **Review and Launch** button.

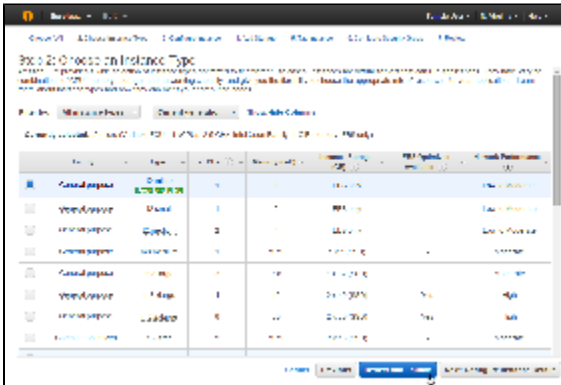

Review & Launch

You will now be presented with a range of options to finish configuring the instance to suit your specific needs.

10. Once configured, click the **Launch** button.



You will now be prompted to define key pairs. For the purposes of this example, we are not going to use a key pair, but you can define them as required for security purposes.

Note: if you want to be able to access the log files and other configuration items outside of the UI, or you wish to patch Yellowfin in the future you will **need** you use a key pair.

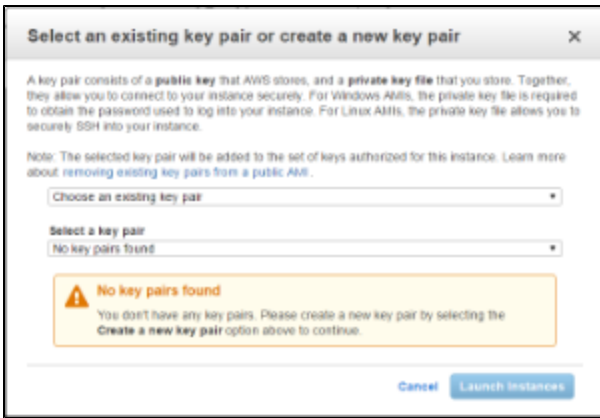

11. Define key pairs, or select the **Proceed without a key pair** option.

12 Click the **Launch Instance** button.

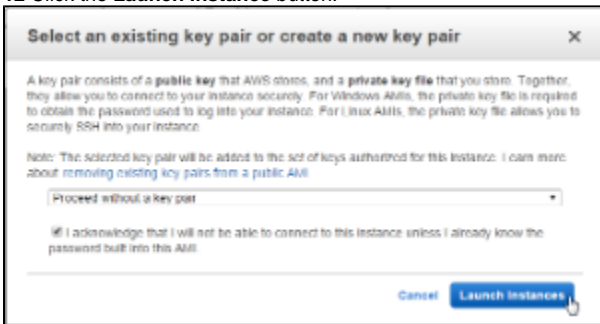

View Instances

Your instance will now be launching and should be ready shortly.

13. Click on the **View Instances** button in order to see a list of your available instances.

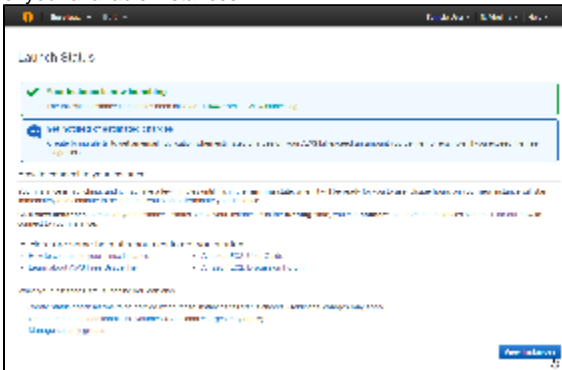

Instance Name

While your instance is initialising it's a good time to name it.

14. Click on the pencil icon to provide it with a name.

15. Enter a name and click on the tick button to apply it.

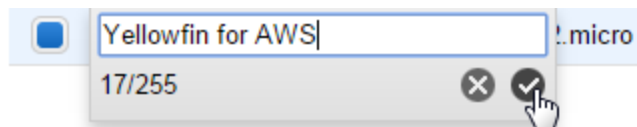

Public IP

Once the instance is running, you will need to identify the IP address assigned in order to access Yellowfin.

16. Click on the **Description** tab while the instance is selected and find the Public IP.

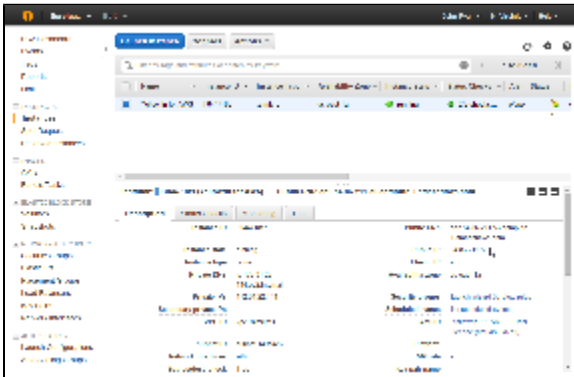

Yellowfin

[top](#)

Open Yellowfin

1. Open a web browser and access your instance using your IP found in the previous section, for example: <http://54.86.211.56>.

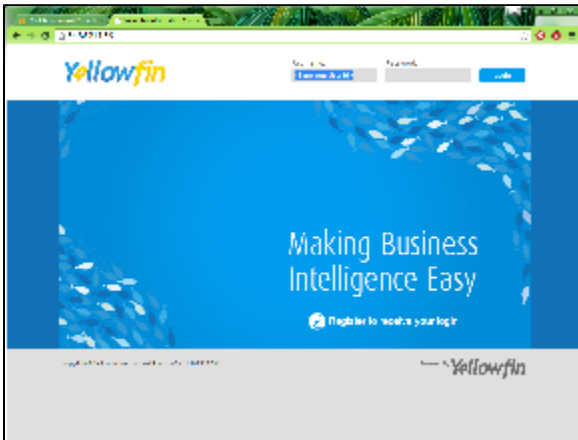

Register Yellowfin

From here, you will need to register in order to receive the login details to your instance.

2. Click on the *Register link.



You will now need to fill in the registration form in order to use the 1 year evaluation copy of Yellowfin.

Once the form is complete, you will no longer see the registration link on the Yellowfin Login page.

Thanks for choosing try Yellowfin

To register your 1 year evaluation copy of Yellowfin, please complete the registration form below

Name

Job Title

Contact

Company

Address

Website

Proposed Interest

☒ Customer

☐ Reseller

☐ ISV Partner

Submit

Cancel

When you receive the registration confirmation email, you will find username and password information, along with some helpful **getting started** links.

Yellowfin

Introducing Yellowfin for AWS

Congratulations

You have started up and registered your Yellowfin AWS instance, and are now ready to login. We cannot wait for you to try this for yourself.

How to login



Username

[yellowfin@yellowfin.com.au](#)

Password

[1234](#)

(We strongly recommend you change the password and create your own user when you are ready to use your own data)

We designed this AWS instance of Yellowfin to make your life easy

1 Ready to go AWS deployment: We've even thrown in demo dashboards and tutorials to show you what Yellowfin can do

2 Free 1 year license for 3 users: We'd rather you buy once you see value, and know you're ready

3 Connect to Redshift: Yellowfin connects to almost any data source, including Redshift, and we've added some additional information below to help you get started

Getting Started



Docs



Video



Consultation Request



Redshift

[top](#)